



## Longcrofte Road

Edgware

£573,950

A first floor, two bedroom flat available chain free with Davidson Frost-Wellings.

The flat has a large reception room with Juliette balcony, and a separate eat-in kitchen. There is also an impressive master suite with built-in wardrobes and ensuite bathroom, plus a second bedroom and family bathroom.

Bartholomew Court is a modern, purpose built building in an excellent location for local shops and transport links, with allocated parking and communal gardens.

Harrow Council Tax Band F.

### Viewing

Please contact our Davidson Frost-Wellings Office on 020 8954 8806 if you wish to arrange a viewing appointment for this property or require further information.

- Two bedrooms
- Two bathrooms
- Chain free
- Separate eat-in kitchen
- Communal gardens
- Allocated parking



2



2



1





Floor Plan

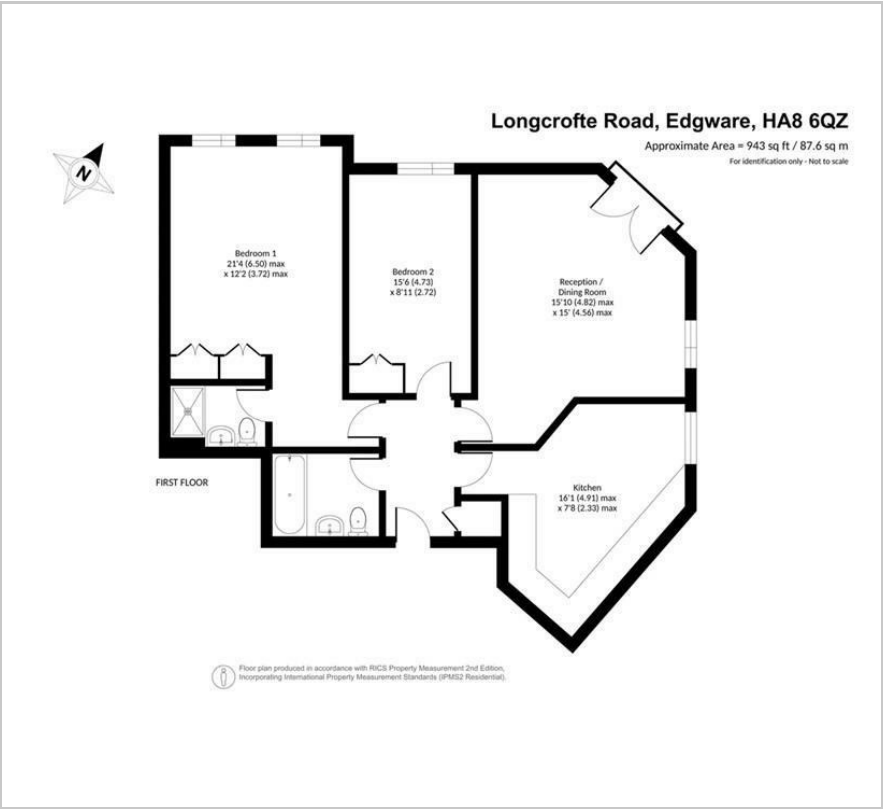

Area Map

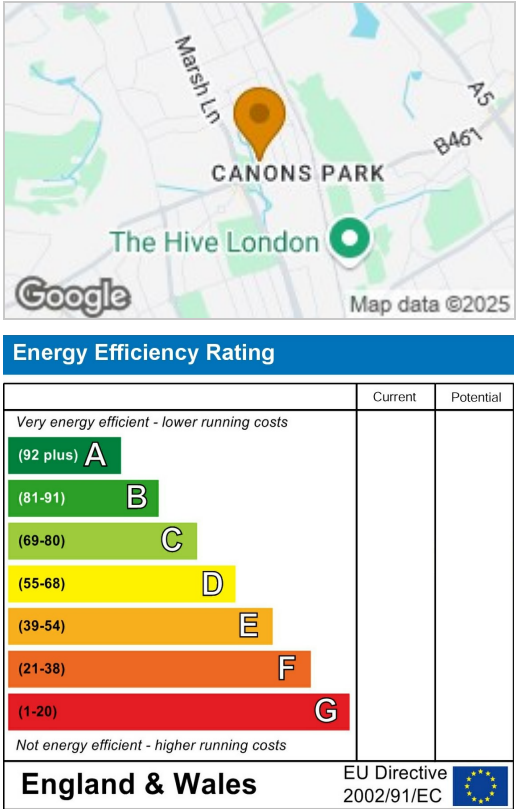

These particulars, whilst believed to be accurate are set out as a general outline only for guidance and do not constitute any part of an offer or contract. Intending purchasers should not rely on them as statements of representation of fact, but must satisfy themselves by inspection or otherwise as to their accuracy. No person in this firms employment has the authority to make or give any representation or warranty in respect of the property.